

LPS® CP Series

SURGE PROTECTIVE DEVICES

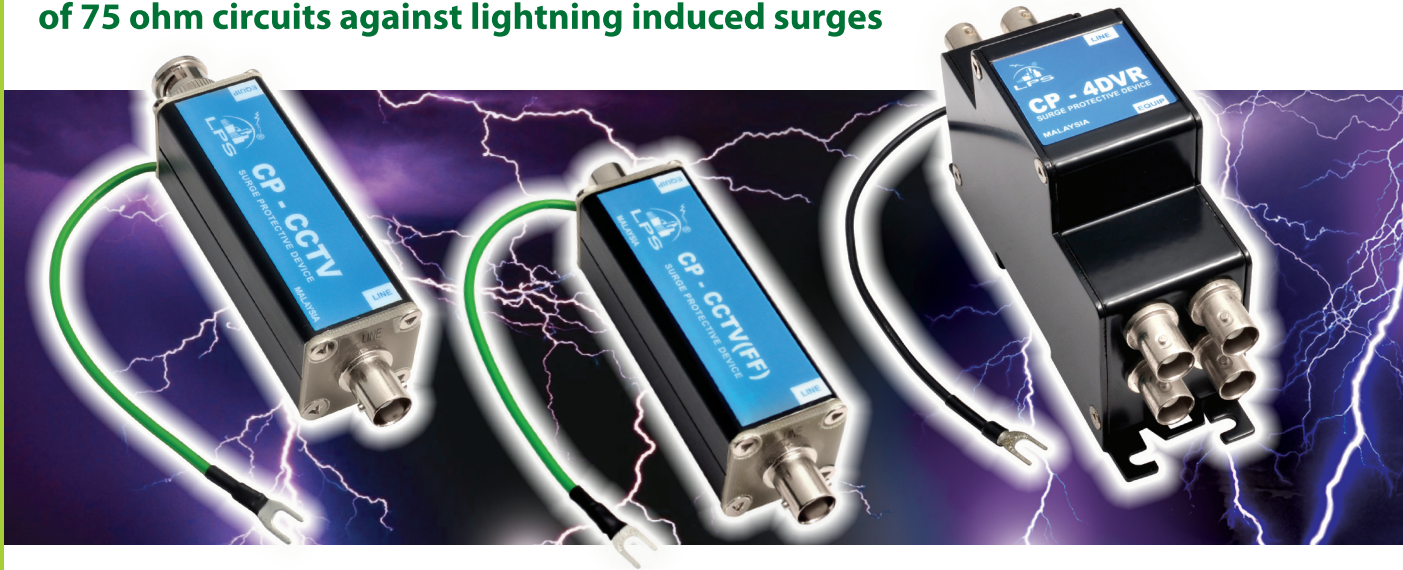

Protect coaxial communication lines with BNC connectors of 75 ohm circuits against lightning induced surges



The LPS® CP Series devices are reliable surge protective devices designed to protect coaxial communication lines with BNC (Bayonet Neill–Concelman) connectors of 75 ohm circuits. Following extensive R&D, these devices were designed with high surge capacity to provide unsurpassed performance in lightning surge protection.

Under this Series, the LPS® CP–CCTV device is ideal for video signals for CCTV cameras and DVR (Digital Video Recorders). The LPS® CP–CCTV (FF) device has BNC female connectors at both ends, while the LPS® CP–4DVR offers an economical solution which protects 4 DVR channels.

With state-of-the-art engineering technology, these LPS® CP Series can protect your equipment effectively even in the most lightning prone regions in the world. They will keep safe sensitive signal networks against lightning induced surges without impairing the system's normal operations or causing excessive in-line resistances.

How they work

The LPS® CP Series devices that are manufactured in Malaysia provide a multi-stage hybrid protection. Primary protection starts with GDT (Gas Discharge Tube) which is then supported with a second-stage surge attenuate component, followed by a TVS (Transient Voltage Suppressor) and finally to a MOV (Metal-oxide Varistors). When surges occur, these devices will switch to a fully conductive state and divert current, after which it will reset automatically. However, under excessive surge conditions, the LPS® CP Series devices will short circuit to earth, securing the protection of the equipment. The impedance of the devices is carefully adjusted by a network to match a 75 ohm circuit to avoid any mismatched reflection of signals (except CP–4DVR).

For more effective protection, we highly recommend that the LPS® CP Series devices be installed at both ends of the coaxial cable, especially when the connecting equipment is located 30 metres away, in an adjacent building or outdoors.

HIGHLIGHTS

- ▶ They are multi-stage hybrid protectors
- ▶ They protect coaxial communication lines with BNC connectors
- ▶ They match network characteristics impedance
- ▶ No interference from different earth potential between cable ends
- ▶ They protect all modes from centre to screen and screen to earth
- ▶ They can be mounted on a standard 19" CP Rack for a maximum of up to 12 channels

Technical Specifications

Technical Data	CP-CCTV, CP-CCTV (FF)	CP-4DVR
Signal Type	1 V P-P Standard Video Signal	
Nominal Operating Signal Voltage	±1 V	
Maximum Operating Signal Voltage	±2 V	
Standard Clamp Voltage @ 1 mA	±2 V (Centre Conductor to Screen) 82 V (Screen Conductor to Earth)	±2 V (Centre Conductor to Earth)
Let-through Voltage @ IEEE C62.36 – 1994 (CCITT) / ITU-T k.20, Enhanced 6 kV @ 10/700 µs, 150 A @ 5/310 µs	5 V (Centre Conductor to Screen) 110 V (Screen Conductor to Earth)	5 V (Centre Conductor to Earth)
Maximum Surge Current @ 8/20 µs	10 kA (Centre Conductor to Earth) 11 kA (Screen Conductor to Earth)	10 kA (Centre Conductor to Earth)
– 3db Bandwidth @ 75 Ω Circuit	From DC to 140 MHz	
Insertion Loss @ 75 Ω Circuit	< 0.5 db	
Maximum Signal Current	350 mA (Centre Conductor to Screen)	
Maximum Shunt Capacitance	< 30 pF	
Loop Resistance	4 Ω	2 Ω
Protection Modes	Common and Transverse Modes	
Impedance	75 Ω	
Operation and Storage Temperatures	– 40° C to 70° C	
Warranty	5 years	

Model Number	Connector Interface		Weight
	Equipment	Line	
CP-CCTV	1 BNC Male	1 BNC Female	86 g
CP-CCTV (FF)	1 BNC Female	1 BNC Female	82 g
CP-4DVR	4 BNC Female	4 BNC Female	300 g

Accessory	Application	Dimension	Weight
CP Rack	Rack mounting for a maximum of 12 CP-CCTV (FF) units	19" (W) x 1U (H)	550 g

Dimensions

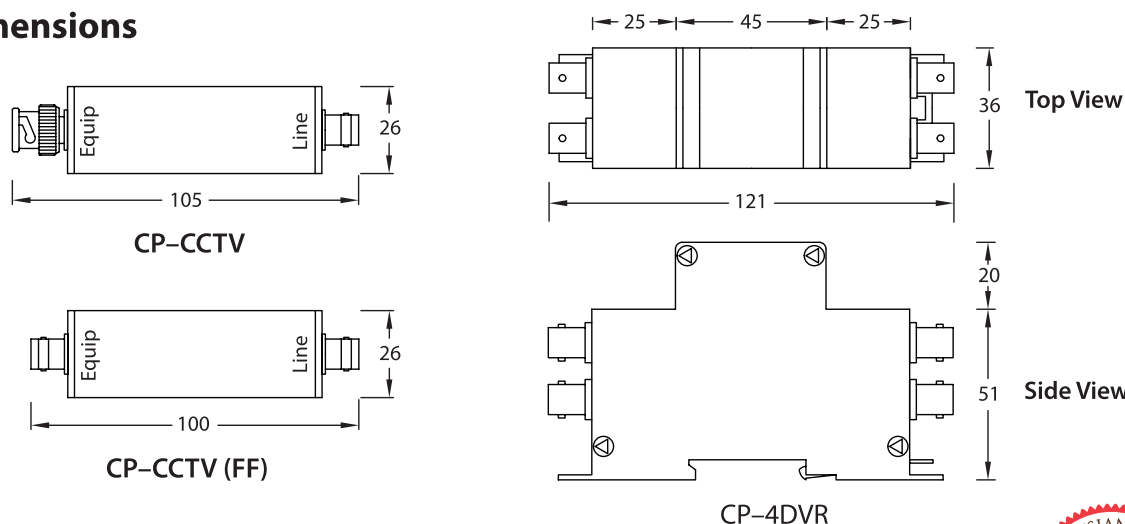

All dimensions in millimetres

All the above specifications are subjected to changes without prior notice.
Customised products are available upon request.

Awarded the National Mark of
Malaysian Brand 2015



Lightning Protection System Sdn. Bhd. (362924-D)

No. 42-4, Jalan Kuchai Maju 10, Kuchai Entrepreneurs' Park, 58200 Kuala Lumpur, Malaysia
T: +603-7980 5911 • F: + 603-7980 4862 • E: info@lpsystem.com • www.lpsystem.com

